

## Rentals

### Resort Boat

\$10/day, \$55/week

\* Boat free with Motor Rental

### Motor

15Hp \$50/day, \$250/week

### Extra Dock

\$10/day

## Yours To Enjoy At No Extra Cost

Canoe  
Paddleboats  
Kayaks  
Volleyball  
Ping Pong  
Horse Shoes  
Basketball  
Woodburning Sauna  
Bonfire Nightly  
TV in Lodge & Movies  
Swings & Slide  
Cribs & High Chairs

## Deposits

Weekly \$700 - 4 bedroom

\$600 - 3 bedroom

\$400 - 2 bedroom

Daily \$125

## Cancellation Policy:

If you cancel at least 90 days before your confirmed reservation and the cabin is re-rented, your deposit less 35% will be refunded.

*Guests are responsible for full length of confirmed stay.*

## We Accept:

MasterCard, Visa & Discover

## Lodge

On rainy days or just for a break from the sunny weather and beach come into our lodge and enjoy a friendly game of pool or a video game. We also have candy, pop, Schwan's ice cream and pizza for a snack.

## Seasonal R.V. Accommodations

We have 5 sites equipped with sewer, water, electricity, picnic tables and fire rings. The sites are 20'x40' with 10' on each side. All are level and are about 100 yards from the lake.

May to October 1

1-2 People . . . . . \$2,800.00

Extra Per Adult . . . . . \$1,000.00

Extra Per Child . . . . . \$500.00

Overnight Guests - All Ages . . . . . \$20.00

**SITES ARE METERED FOR ELECTRICITY  
& WILL BE BILLED PER POWER COMPANY**

## Directions To Bay View Lodge

\*Take Hwy. 371 North from Brainerd to Pequot Lakes.

\*Continue on Hwy. 371 North, 2 miles to Co. Rd. 16.

\*Turn Right on Co. Rd. 16, East 10.2 miles to Harbor Lane Road.

\*Turn Left & go 1/2 mile to sign.

-OR-

\*Take Hwy. 210 from Brainerd to Hwy. 25.

\*Turn Left on Hwy. 25 North thru Merrifield to Co. Rd. 3.

\*Turn Right on Co. Rd. 3 to Crosslake.

\*At Crosslake take Co. Rd. 66 thru town to Co. Rd. 16.

\*Left on Co. Rd. 16, 2.5 miles to Harbor Lane Road.

\*Right on Harbor Lane Road 1/2 mile.

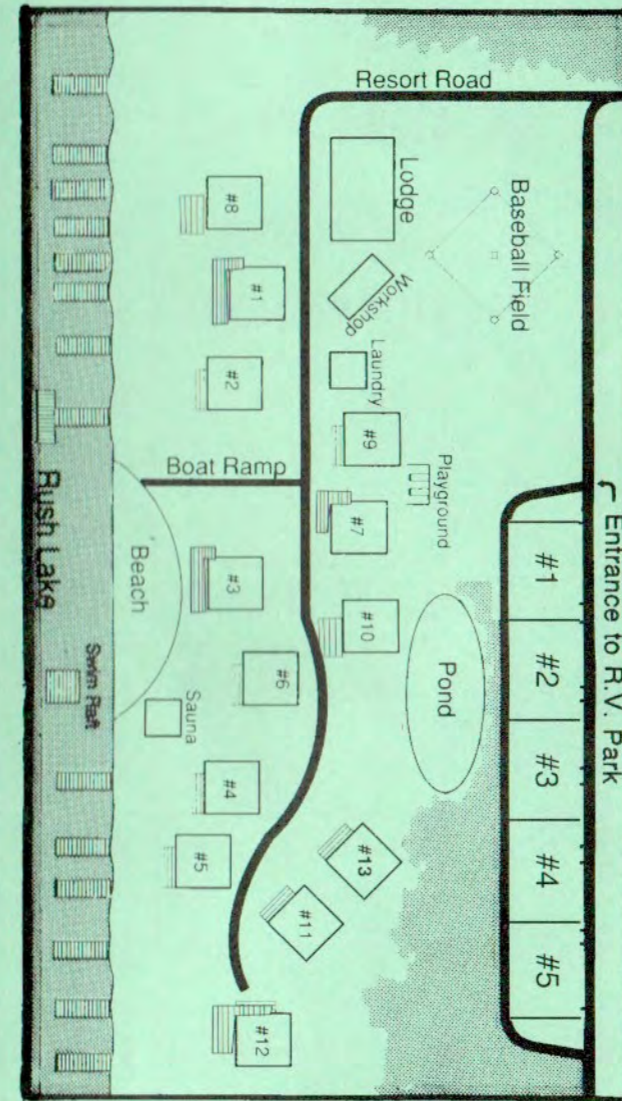

# 2012 Rate Schedule

*Jim & Mary Ann Berg*

12038 Harbor Lane, Crosslake, MN  
56442

218-543-4182

OR

888-543-4182

[www.bayviewlodgeonrushlake.com](http://www.bayviewlodgeonrushlake.com)

# 2012 Rates

CABIN NO. & DESCRIPTION	W	E	E	K	L	Y	* D A I L Y * MAY & SEPTEMBER ONLY	
	5/1-6/2	6/2-6/16	6/16-6/23	6/23-8/18	8/18-8/25	8/25-9/30	1-2 DAYS MEM. DAY & LABOR DAY	3-5 DAYS
1 4 BEDROOMS: on lake, deck, 1 double bed, 2 queen, 2 twin, 2 baths, hide-a-bed. (Rate up to 8 persons)	\$1,195	\$1,765	\$2,265	\$2,390	\$1,960	\$1,515	\$225	\$205
2 3 BEDROOMS: on lake, deck, 2 queen beds, 2 twin, hide-a-bed. (Rate up to 6 persons)	\$ 985	\$1,395	\$1,815	\$1,970	\$1,610	\$1,285	\$185	\$165
3 3 BEDROOMS: on lake, deck, 2 queen beds, 2 twin, hide-a-bed. (Rate up to 6 persons)	\$ 985	\$1,395	\$1,815	\$1,970	\$1,610	\$1,285	\$185	\$165
4 3 BEDROOMS: on lake, deck, 1 queen bed, 1 double, 2 twin, hide-a-bed. (Rate up to 6 persons)	\$ 985	\$1,395	\$1,815	\$1,970	\$1,610	\$1,285	\$185	\$165
5 3 BEDROOMS: on lake, deck, 2 double beds, 1 queen, hide-a-bed. (Rate up to 6 persons)	\$ 925	\$1,320	\$1,750	\$1,865	\$1,530	\$1,210	\$165	\$145
6 3 BEDROOMS: with good lake view, deck, 2 queen beds, 2 twin, hide-a-bed, ceiling fans. (Rate up to 6 persons)	\$ 985	\$1,395	\$1,815	\$1,970	\$1,610	\$1,285	\$185	\$165
7 3 BEDROOMS: overlooks beach, deck, 1 queen bed, 1 double, 2 twin. (Rate up to 6 persons)	\$ 885	\$1,220	\$1,620	\$1,765	\$1,430	\$1,110	\$160	\$140
8 4 BEDROOMS: on lake, deck, 5 double beds, 1 queen, 1 twin, 2 baths, hide-a-bed, ceiling fans. (Rate up to 8 persons)	\$1,295	\$1,865	\$2,365	\$2,490	\$2,060	\$1,615	\$250	\$230
9 4 BEDROOMS: lakeview, deck, 4 double beds, 2 twin, 1 queen, hide-a-bed, 2 baths, ceiling fans. (Rate up to 8 persons)	\$1,195	\$1,765	\$2,265	\$2,390	\$1,960	\$1,515	\$225	\$205
10 2 BEDROOMS: lakeview, deck, 1 queen bed, 2 twin, hide-a-bed, ceiling fans. (Rate up to 4 people)	\$ 850	\$1,165	\$1,490	\$1,665	\$1,330	\$ 1,025	\$160	\$140
11 4 BEDROOMS: lakeview, deck & screen porch, 1 double bed, 2 queen, 2 twin, hide-a-bed, 2 baths, ceiling fans. (Rate up to 8 persons)	\$1,195	\$1,765	\$2,265	\$2,390	\$1,960	\$1,515	\$225	\$205
12 3 BEDROOMS: on lake, deck, 2 queen beds, 2 twin, hide-a-bed, ceiling fans. (Rate up to 6 persons)	\$1,025	\$1,435	\$1,865	\$2,060	\$1,655	\$1,325	\$195	\$175
13 3 BEDROOMS: lakeview, deck & screen porch, 2 queen beds, 2 twin, hide-a-bed, fireplace, ceiling fans. (Rate up to 6 persons)	\$1,025	\$1,435	\$1,865	\$2,060	\$1,655	\$1,325	\$195	\$175

ALL RATES SUBJECT TO MN SALES TAX - 6.875% AND LOCAL LODGING TAX - 1%. **2% Discount for checks or cash**

\* Daily May and September only. **JUNE, JULY, AND AUGUST- 1/7 WEEKLY RATE**

## June, July, August Daily Rates

Rate will be 1/7th weekly rate upon availability.

## Spring & Fall Specials

May & September  
 2 People-Cabins 4, 5, 7, & 10 - **\$795/wk**  
 2 People-Cabins 3, 6 & 13 - **\$850/wk**  
 All upon availability

## Special Notes:

Additional persons (any age) **\$35/night**  
 We reserve the right to limit number of persons in cabin.

Each cabin has  
 Knotty pine interiors  
 Berber carpeting throughout  
 Cable TV  
 TV's with DVD Player  
 Microwave, Mixers, Hair Dryer  
 Mr. Coffee, Toaster, Crock Pot  
 Weber charcoal grill  
 Picnic table  
 Iron and ironing boards  
 2-Deck chairs

All Cabins are housekeeping  
 All bed linen provided  
 Bring your own soap & towels

Sorry - No Camping - No Pets

## DAILY VISITORS MUST REGISTER AT OFFICE.

There will be a **\$15 per person** per day charge.

## Plan to Arrive

Saturdays - AFTER 4 p.m.  
 Daily - Call for time

## Plan to Leave

Saturdays - BEFORE 9 a.m.  
 Daily - Call for time